

**M85049/128 (AS85049/128) Welded Termination Bands**

Compaero is a QPL'd manufacturer of AS85049/128 Termination Bands. These bands, formed from 300 series stainless steel, utilize either a one-step (stamped buckle) or two-step (welded buckle) termination method to terminate shield to an adapter. Termination bands are available in standard length, mini length (and width) and extended length. See the table below for dimensional data.

**For tooling information and installation instructions see Section J.**



Stamped Buckle



Welded Buckle

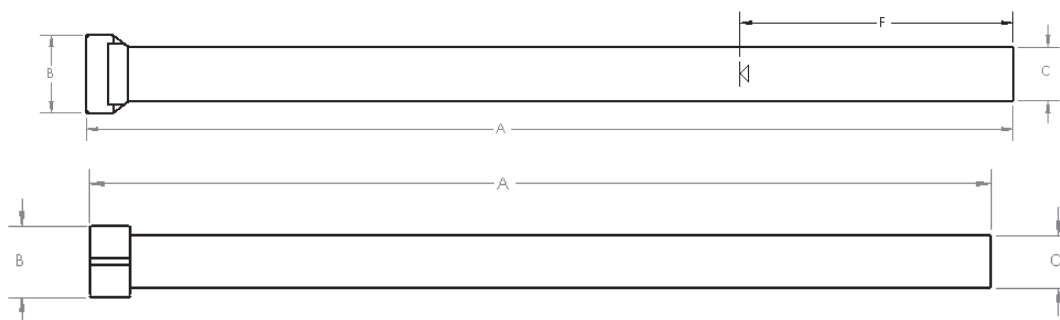

STAINLESS STEEL TERMINATION BANDS

COMPAERO ORDERING CODE	TERMINATION BAND PART NUMBER	DESCRIPTION	A ± .060	B ± .031	C ± .010	F REF
W	M85049/128-1	STANDARD, WELDED BUCKLE	14.000	0.328	0.245	-
W1	M85049/128-2	PRE-COILED STANDARD, WELDED	-	-	-	-
B	M85049/128-3	STANDARD, STAMPED BUCKLE	14.256	0.350	0.250	2.031
B1	M85049/128-4	PRE-COILED STANDARD, STAMPED	-	-	-	-
N	M85049/128-5	MICRO, WELDED	9.500	0.198	0.118	-
N1	M85049/128-6	PRE-COILED MICRO, WELDED	-	-	-	-
M	M85049/128-7	MICRO, STAMPED	8.125	0.195	0.120	2.031
M1	M85049/128-8	PRE-COILED MICRO, STAMPED	-	-	-	-
X	CPTB-222	MICRO EXTENDED LENGTH, WELDED	14.250	0.198	0.118	-
X1	CPTB-222-1	PRE-COILED MICRO EXTENDED LENGTH	-	-	-	-

**DISCLAIMER:** All information is believed to be reliable. Readers should independently evaluate the suitability of each product for their application. Compaero makes no warranties as to the accuracy or completeness of the information herein and disclaims any liability regarding its use. Specifications are subject to change without notice. Compaero reserves the right to make changes, without notification to the customer, to processing or materials that do not affect compliance with any applicable specification. **Drawings are not to scale.**

**Stainless Steel Constant Force Spring Band Option**

Spring bands are re-usable and self tensioning to secure both overall and individual braid termination. The spring is easy to install and requires no tooling while providing a high level of tensile strength to the assembly. The constant force springs are suitable for corrosive environments and are not affected by vibration, shock or extreme temperatures. Use Compaero Order Code 'S' to have a constant spring band included with the adapter. Compaero will determine the appropriate size needed based on the Cable Entry called out on the part number.

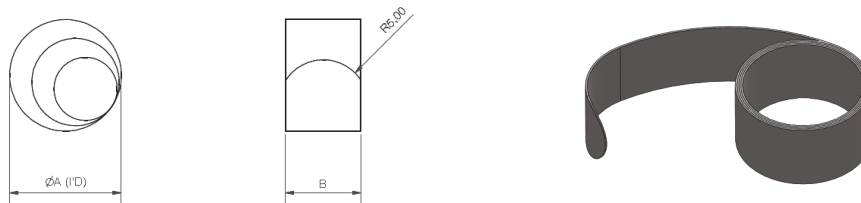

TABLE I - STAINLESS STEEL SPRING BAND				
COMPAERO ORDER CODE	HELLERMANN SPRING BAND	A MAX	B +/- 0.2	TURNS +/- 0.25
S	HE050	.295 (7.5)	.374 (9.5)	
S	HE100	.315 (8.0)	.374 (9.5)	4.5
S	HE200	.504 (12.8)	.374 (9.5)	3
S	HE300	.705 (17.9)	.374 (9.5)	4.25
S	HE400	.858 (21.8)	.374 (9.5)	3.5

**Memory Ring Option (See Series 49 for part number breakdown)**

The memory ring adapter utilizes a memory ring to terminate the overall shield to the adapter. The memory ring is a low-profile, high-strength, shape-memory-alloy shield-termination device available in many sizes to accommodate various entry sizes and shield configurations. Memory ring adapters are ideal for lightweight aerospace applications requiring repeated high-to-low temperature cycles.



**AI** = Ring accommodates a single 36 AWG braid per QQB-575.

**BI** = Ring accommodates a single 36 AWG braid or double 36 AWG braids per QQB-575

MEMORY RING SPECIFICATIONS						
COMPAERO PART NUMBER	USED WITH CABLE ENTRY SIZE	ADAPTER 'G' DIA	PART NUMBER (TYPE AI)		PART NUMBER (TYPE BI)	
			END CPTR PART NUMBER WITH AI	RECOVERED	END CPTR PART NUMBER WITH BI	RECOVERED
<b>CPTRxxAI</b> <b>CPTRxxBI</b>	SEE SERIES 49	SEE SERIES 49	AS SUPPLIED	RECOVERED	AS SUPPLIED	RECOVERED
CPTR04	02	0.373	.397	.379	.416	.398
CPTR05	32	0.435	.460	.440	.479	.458
CPTR06	03	0.498	.523	.499	.548	.523
CPTR07	33	0.560	.586	.559	.606	.578
CPTR08	04	0.623	.650	.620	.670	.639
CPTR10	05	0.747	.782	.744	.802	.763
CPTR12	06	0.872	.912	.867	.931	.886
CPTR14	07	0.997	1.040	.988	1.060	1.007
CPTR16	08	1.122	1.171	1.111	1.191	1.129
CPTR18	09	1.247	1.301	1.234	1.320	1.252
CPTR20	10	1.372	1.430	1.357	1.450	1.376
CPTR22	11	1.495	1.543	1.463	1.561	1.481
CPTR24	12	1.620	1.673	1.587	1.691	1.605

**DISCLAIMER:** All information is believed to be reliable. Readers should independently evaluate the suitability of each product for their application. Compaero makes no warranties as to the accuracy or completeness of the information herein and disclaims any liability regarding its use. Specifications are subject to change without notice. Compaero reserves the right to make changes, without notification to the customer, to processing or materials that do not affect compliance with any applicable specification. **Drawings are not to scale.**