

# STRAIGHT, 45° & 90° ADAPTERS

For Connectors: MIL-DTL-38999, Series III & IV  
Shield Termination, Boot Accommodation

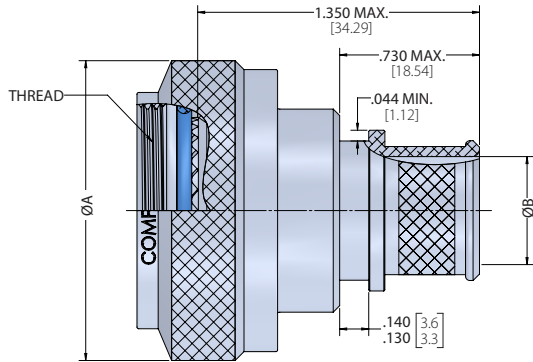

**Straight**



**45° Angled**

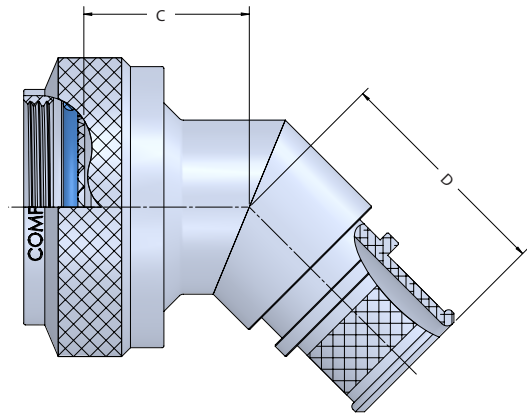

**90° Angled**

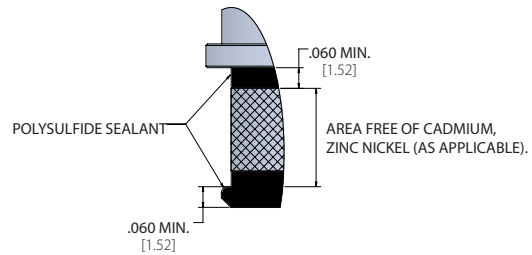
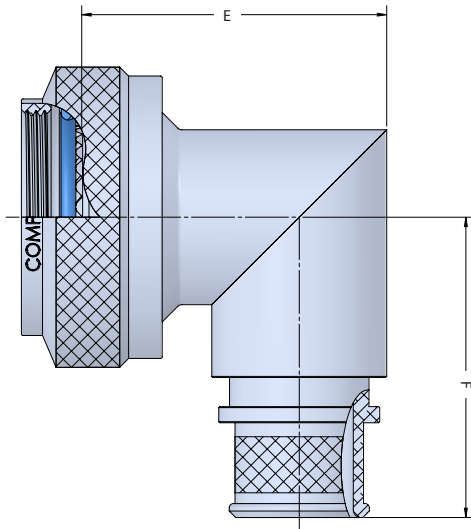

## Polysulfide Option

For MIL Finish Codes : P & ZP

## CP85049/ 88 - 9 P 03

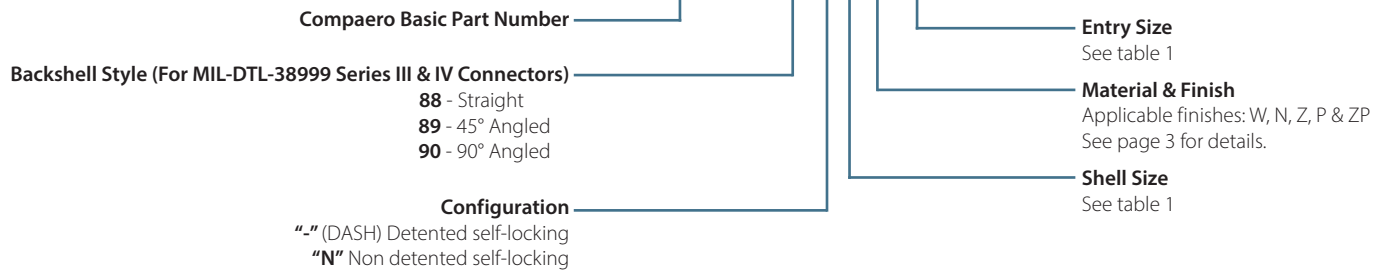

**inches** [millimeters]  
 THIS DRAWING IS THE PROPERTY OF COMPAERO, INC AND MUST NOT BE USED FOR COMMERCIAL PURPOSES WITHOUT WRITTEN CONSENT OF THE COMPANY. DRAWING CORRECT AT TIME OF PUBLISHING.

# STRAIGHT, 45° & 90° ADAPTERS

For Connectors: MIL-DTL-38999, Series III & IV  
Shield Termination, Boot Accommodation

**COMPAERO**



**Table 1** Shell & Entry Sizes

SHELL SIZE	ENTRY SIZE	THREAD	ØA MAX.		ØB		C MAX.		D MAX.		E MAX.		F MAX.	
			in	mm	+0.025	+0.64	in	mm	in	mm	in	mm	in	mm
					-0.010	-0.25								
9	02	M12X1.0-6H	0.858	21.80	N/A	N/A	1.01	25.7	1.16	29.5	1.375	34.93	1.417	35.99
	03				0.250	6.40								
11	02	M15X1.0-6H	0.984	25.00	N/A	N/A	1.03	26.2	1.19	30.2	1.437	36.50	1.480	37.59
	03				0.312	7.92								
13	02	M18X1.0-6H	1.157	29.40	0.312	7.92	1.06	26.9	1.21	30.7	1.562	39.67	1.553	39.45
	03				0.438	11.13								
15	02	M22X1.0-6H	1.279	32.50	0.438	11.13	1.08	27.4	1.24	31.5	1.687	42.85	1.614	41.00
	03				0.562	14.30								
17	02	M25X1.0-6H	1.406	35.71	0.500	12.70	1.11	28.2	1.26	32.0	1.750	44.45	1.678	42.62
	03				0.625	15.90								
19	02	M28X1.0-6H	1.516	38.51	0.625	15.90	1.12	28.4	1.27	32.3	1.875	47.63	1.773	45.03
	03				0.750	19.10								
21	02	M31X1.0-6H	1.642	41.71	0.625	15.90	1.15	29.2	1.30	33.0	1.938	49.23	1.796	45.62
	03				0.812	20.62								
23	02	M34X1.0-6H	1.768	44.91	0.688	17.50	1.17	29.7	1.33	33.8	2.062	52.37	1.859	47.22
	03				0.938	23.83								
25	02	M37X1.0-6H	1.889	48.00	0.750	19.10	1.20	30.5	1.35	34.3	2.125	53.98	1.919	48.74
	03				1.000	25.40								

Metric equivalents are given for general information only and are based upon 1.00 inch = 25.4 mm.

MIL FINISH CODE	BASE MATERIAL OF ADAPTER BODY AND COUPLING RING	DESCRIPTION
A	Aluminum Alloy	Black Anodize - in accordance with Class 2 of MIL-A-8625, Type II, -65° to +175° C. 500 Hour Salt Spray.
W	Aluminum Alloy	Cadmium - Olive Drab over suitable underplate, -65° to +175° C. (Not for use in space application) 1000 Hour Salt Spray.
N	Aluminum Alloy	Electroless Nickel - in accordance with AMS-C-26074 or AMS2404, -65° to +200° C. (Not for Navy use) 96 Hour Salt Spray.
Z	Aluminum Alloy	Zinc Nickel in accordance with ASTM B841 over suitable underplate. Color shall be Black, Conductive and Non-Reflective. Final finish shall be electrically Conductive, -65° to +175° C. (Not for use in space application) 1000 Hour Salt Spray.
P	Aluminum Alloy	Cadmium (Olive Drab) over electroless nickel, with Polysulfide sealant strips, Selective Plating, -65° to +175° C. (Not for use in space application) 96 Hour Salt Spray.
ZP	Aluminum Alloy	Zinc Nickel over electroless nickel, with Polysulfide sealant strips, Selective Plating, -65° to +175° C. (Not for use in space application) 96 Hour Salt Spray.

Please note that the colours shown above are for illustrative purposes only-actual finish colour may vary.